



# **Honoring Families**

**Helping Children and Youth Succeed**

April 27-29, 2005

## Thank You to Our Conference Sponsors

Oklahoma Department of Mental Health  
and Substance Abuse Services

**The Oklahoma Department of Mental Health and Substance Abuse Services**



Substance Abuse and Mental Health Services Administration  
**Center for Substance Abuse Prevention**  
[www.samhsa.gov](http://www.samhsa.gov)



**U.S. Department of Health and Human Services, SAMHSA**  
*The Center for Substance Abuse Treatment*

**and**

**Technical Assistance Partnership of America**

**Oklahoma State Department of Health**

**Department of Rehabilitation Services**

**Oklahoma Commission on Children and Youth**

**Oklahoma Juvenile Affairs**

**Department of Human Services**



**Secretary of Health**

*Honoring Families: Helping Children and Youth Succeed*

Dear Participants,

On behalf of the Oklahoma Department of Mental Health and Substance Abuse Services, welcome to Tulsa's Southern Hills Marriott for the 12<sup>th</sup> Annual Children's Behavioral Health Conference. This year's theme is "Honoring Families: Helping Children and Youth Succeed."

Our goal is that all of Oklahoma's children and youth with emotional disturbance will have early and easy access to all the services and supports necessary to remain in their own homes, in their own communities, safely and successfully with hope for the future. We strive to provide effective and evidence based services within a framework that supports these core values: community-based, child-centered/family-focused, and culturally competent.

The conference will provide participants with the opportunity to choose from a variety of concurrent workshops, speakers and topics.

Thank you all for coming to the conference and for working together to help Oklahoma's children, youth and their families succeed!

Sincerely,

*Terry Cline, Ph.D.*

Terry Cline, Ph.D.  
Secretary of Health  
Commissioner

TC/js

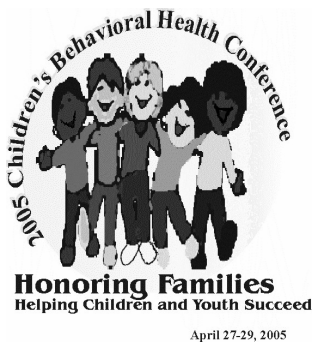

# Welcome to the 2005 Children's Behavioral Health Conference

## ANNOUNCEMENTS

Welcome to the conference! We hope that the educational opportunities planned this year will meet your expectations and help you personally and professionally.

Out of courtesy for participants and speakers, please turn all pagers and telephones to silent mode. Please leave the workshop for cell phone conversations.

Be sure and go by to visit our many exhibitors. There is a list of exhibitors in your conference packet.

Lunch on Friday will be provided for all pre-registered participants. A restaurant list is provided on the reverse side of these announcements.

Don't forget to sign in at the registration desk each morning. This enables us to get a count for each day and to know who is present. Please also sign in at each workshop.

There will be certificates available for all participants. Do not forget to pick up your certificates at the end of the conference since certificates will NOT be mailed. If you come in late or leave early, your actual hours of attendance will be reflected on your certificate. Each individual will be responsible for picking up his or her own certificate.

Special forms for social workers and licensed professional counselors will be attached to your certificates. The general certificate will suffice for other credits.

Invoices or receipts will be attached to your certificates. Don't forget to take the invoices back to your agency accounting offices to be paid.

If you have questions, please ask anyone with a red ribbon. Department of Mental Health and Substance Abuse Services staff and volunteers will be wearing the red ribbons. Each workshop will have staff to assist speakers and participants.

Thank you for being here, and we hope you have a great time at the conference!

\*All presenters declare that neither them nor any immediate family member of their family has a financial arrangement or affiliation with any corporate organization offering financial support or grant monies for this continuing medical education program. Also, they agree no aspect of their current personal or professional circumstances places them in the position of having a conflict of interest with any interest of the Department of Mental Health and Substance Abuse Services relating to their presentation.

## CONFERENCE SPEAKERS AND BIOS



### **Insoo Kim Berg**

Ms. Berg is the co-developer of the Solution-Focused Brief Therapy model that is accepted around the world. She has served as a trainer, consultant, and supervisor to organizations and government programs across North America, Europe, Scandinavia, and Pacific Rim Countries. Many of her nine books and more than 35 papers have been translated into 14 languages.



### **John VanDenBerg, Ph.D.**

Dr. VanDenBerg is an internationally recognized authority on systems of care and the wraparound process for children and youth with complex emotional needs and their families. A child psychologist, he has lectured and trained in all 50 states, Canadian Provinces, and other countries. He has dedicated his professional life to the improvement of services to children and families, and is the President of Vroon VanDenBerg LLP, an innovative firm supporting counties, states, and provinces in their reform efforts.



### **Donna Weston, Ph.D.**

Dr. Weston received her Ph.D. in Developmental Psychology at University of California, Berkeley, and completed a two year internship in infant-parent psychotherapy at the Infant Parent Program at the University of California, San Francisco. She specializes in working with infants, toddlers and their families. She is currently a member of the DC:03 Training Task Force for Zero to Three and is a Candidate in the Course in Child Analysis at the Hanna Perkins Center.



### **Joseph Benamati**

Mr. Benamati is the Center Director for Parsons Child Trauma Study Center, a SAMHSA Trauma Network site. He is a Vietnam Veteran, trained as a combat medic, and assigned to a USAF Hospital mental health unit. He has spent 28 years working in children's mental health programs both outpatient and residentially.



### **Jose Szapocznik, Ph.D.**

Dr. Szapocznik is Director of the Center for Family Studies and Professor of Psychiatry and Behavioral Sciences, Psychology, Educational and Psychological Studies is the premiere training and research facility in the nation on family-based treatment and prevention of minority families



### **Jane Adams, Ph.D.**

Dr. Adams directs Keys for Networking, Inc., the Kansas state organization of the Federation of Families for Children's Mental Health. She recently retired as President of the National Federation of Families Board of Directors. In 2003 she served as President Bush's appointee to the New Freedom Commission on Mental Health. Dr. Adams has authored and co-authored such products as the Keys CD-ROM and online WrapAround Training modules (Strengths-Based Planning, Cultural Competence, Family Involvement, and School Mental Health Collaboration).



## ***CONFERENCE SPEAKERS AND BIOS - CONTINUED***

### **Sandra Bloom**

Dr. Bloom is a Board-certified psychiatrist, is currently President of Community Works, a systems consulting firm specializing in teaching individuals and organizations the necessary skills for creating and sustaining lives and nonviolent systems. Dr. Bloom served as Founder and Executive Director of the Sanctuary programs from 1980-2001, inpatient psychiatric programs for the treatment of trauma-related emotional disorders.



### **Mark Chaffin**

Dr. Chaffin is a Psychologist and Professor of Pediatrics and Clinical Professor of Psychiatry and Behavioral Sciences at the University of Oklahoma Health Sciences Center where he serves as Director of Research for the Section of Development and Behavioral Pediatrics and the OUHSC Center on Child Abuse and Neglect. His recent work has centered on development and clinical trial of evidence-based treatments for children and youth in large public-sector service systems.

### **Robin Gurwitch**

Dr. Gurwitch is a Clinical Associate Professor in the Department of Pediatrics at the University of Oklahoma Health Sciences Center, a Clinical Child Psychologist and Marriage and Family Therapist. She is the Director of the A Better Chance Program for Children with prenatal substance exposure. Dr. Gurwitch's areas of special interest are the impact of terrorism, disaster, and trauma on children and families.



### **Patrick Hinson**

Mr. Hinson was Director of Deaf and Hard of Hearing Services for four years, a 21 day in-patient substance abuse treatment facility in Eastern North Carolina, which serves the entire state. In 2004 Mr. Hinson re-located to Florida, and is working as a clinical therapist for deaf adolescents, and adults in a long term in-patient treatment facility, that specializes in psychiatric treatment of deaf people suffering from severe behavioral and psychological disorders.



### **Sandra Keenan, M.Ed.**

Sandy Keenan is currently the Education Resource Specialist for the Technical Assistance Partnership for Child and Family Mental Health in Washington, DC. She has been recognized nationally for the development of district wide behavioral support programs that benefit all children, as well as the community based collaboration of multiple service providers. She is President of the Executive Committee of the International Council for Children with Behavior Disorders.



## **CONFERENCE SPEAKERS AND BIOS - CONTINUED**

### **Karol L. Kumpfer**

Dr. Kumpfer is an American Indian psychologist who has over 30 years of experience in substance abuse treatment and prevention. She worked closely with the Drug Czar, General Barry McCaffrey at the White House Office of National Drug Control Policy on Policy issues and the National anti-drug media campaign. She is the incoming Board Chair of the Indian Walk-in Center and evaluator for Raindance Youth Services in St. George, Utah.

### **Laura Murray, Ph.D.**

Dr. Murray is a clinical psychologist and an assistant Professor at Boston University School of Public Health in the Center for International Health and Development (CIHD). She is part of the research group and her specialty is in evidence-based based interventions for children, adolescents, and families. Dr. Murray also works at Allegheny General Hospital as a trainer in an evidenced-based trauma and grief focused treatment for children and adolescents. Dr. Murray is particularly sensitive to cross-cultural issues as her primary interest includes international venues.

### **Felicia Neubauer**

Ms. Neubauer worked at a community mental health center where families were in crisis, usually as a result of underlying issues of abuse, domestic violence, and other traumas. She also supervised the Intervention Unit in Burlington County where she often provided consultation to superior court judges, and other systems entities as to what services would help these youth and their families. She also trains other professionals on the empirically validated cognitive behavioral therapy utilized with these populations at the Institute.

### **Jim Rast, Ph.D.**

Dr. Rast is the chief operating officer and senior research and systems consultant for Vroon VanDenBerg LLP. He has over thirty years of experience in human service and health care. He was the principal investigator for a CMHS 5-year longitudinal system of care development project to develop community-based mental health services for children and families in 13 rural counties in S.E. Kansas, a SAMHSA early intervention and prevention project to develop family-centered early intervention services for families with substance abuse.



# AGENDA

**Wednesday, April 27, 2005**  
**Pre-Conference Institute**

---

8:00 – 8:30     **Registration**

8:30 – 4:30     Salons A & B

**Plenary. Working with Children in the Context of Families.** *Insoo Kim Berg.* This presentation will describe a step-by-step approach to negotiate the desired outcome right from the beginning. The model presented will be based on Solution-Focused Brief Therapy approach developed by de Shazer, Berg, and their colleagues. Strategies and skills needed to immediately tap into the client's abilities, resources and hidden strengths will be described in detail. Lecture, skill building exercises and useful questions that generate solutions will be used to practice useful tools that you can take back to the office and begin using immediately.

8:30 – 4:30\*     Sequoia

**Plenary. Confluence of PBIS and Wraparound from the School's Perspective: What Do Schools Need to be involved with both Positive Behavioral Interventions and Supports (PBIS) and Wraparound?**

*John VanDenBerg, Ph.D. and Sandy Keenan.* This workshop will be led by John VanDenBerg, Ph.D., national expert on wraparound, and Sandy Keenan, Senior Advisor for the Technical Assistance Partnership for Child and Family Mental Health, a national expert on Positive Behavioral Interventions and Supports. It is a day-long interactive forum designed for educators who are committed to the Values and Principles of Systems of Care and yet have to maintain a high quality of educational services. Educators will receive practical tips on addressing not only educational needs of children with complex needs, but also in dealing more effectively with children who have needs that go beyond the school environment.

8:30 – 4:30\*     Redbud

**Plenary. DC:0-3 Training.** *Donna Weston, Ph.D.* In this lively and interactive session, participants will learn through case examples, lecture, videotape and discussion. This workshop addresses how and why DC:03 was developed; underlying philosophy and approach; principles of effective mental health and developmental assessment of infants and toddlers; the five axes and the major diagnostic categories in DC: 0-3; and use of decision trees and crosswalks to DSM-IV-TR or ICD 9/10. Suggestions for continuing the learning process, and follow up to this session will be discussed



*Thursday, April 28, 2005*

**2005 CHILDREN'S BEHAVIORAL HEALTH CONFERENCE**

**Honoring Families**

**Helping Children and Youth Succeed**

---

8:00 – 8:30 **Registration and Continental Breakfast (Please sign in each day)**  
**Welcome and Opening Remarks.** *Terry Cline, Ph.D.*, Commissioner, Oklahoma Department of Mental Health and Substance Abuse Services.  
**Ramana Award presentation.**  
***Honoring Families Video.***

8:30 – 10:00\* Sequoia  
**Plenary Session. Moving a Community from Collaboration to Integration: Ensuring Better Outcome and Use of Taxpayer Funding.**  
*John VanDen-Berg, Ph.D., and Jane Adams, Ph.D.* Children and youth with complex needs across systems often have multiple and competing plans developed by well meaning professionals who collaborate with each other but whom, at the end of the day, go back to their agencies and schools and make single system decisions. This practice results in a huge waste of taxpayer funding and in poor outcomes for families. This workshop examines the leadership needed to have a truly integrated services process and techniques of ensuring a permanent change in how services are approached.

10:00 – 10:15 **Break**

10:15 – 11:45 Sequoia  
**Plenary Session. When Children and Their Families are Hurting.**  
*Insoo Kim Berg.*

11:45 – 1:00 **Lunch on your own**

1:00 – 2:30 **Concurrent Workshops. Session 1**

1A.\* Sycamore  
**Building a Family-Driven System of Care.** *Jane Adams, Ph.D.* Jane has pioneered the very successful family involvement in Kansas, and is a member of the President's New Freedom Commission. She will share the model used by Keys For Networking in Kansas to nurture family involvement from the first phone call a family makes for help, all the way to the family's involvement in state-level policy making.

1B.\* Silver Oak A  
**Trauma-focused Cognitive Behavioral Therapy with Children Exposed to Family Violence and Their Nonoffending Caregivers.**  
*Felicia Neubauer, Ph.D.* This workshop is based on a trauma-focused cognitive behavioral approach to therapy with children who have witnessed or have been exposed to family violence. The Specific techniques for children,

adolescents, and nonoffending parents/caregivers will be described, including use of role plays for hands-on experience. There will be a brief description of the research describing the effectiveness of this treatment approach.

1C.\*

Birch

**The S.E.L.F. Model of Trauma Treatment: Creating Sanctuary for Traumatized Children and Adolescents in Residential Treatment.** *Sandra Bloom, M.D.* The Sanctuary Model® represents a trauma-informed method for creating or changing an organizational culture in order to more effectively provide a cohesive context within which healing from psychological and social traumatic experience can be addressed. In this workshop we will focus on Creating Sanctuary in residential treatment programs for children and adolescents with emotional and behavioral problems and histories of maltreatment and exposure to family or community violence utilizing a trauma recovery treatment framework called S.E.L.F.

1D.\*

Dogwood

**Community Development: From Collaboration to Integration.** *Jim Rast, Ph.D. and John VanDenBerg, Ph.D.* Systems of Care are how communities come together to support the children and families in the community. This presentation will review the literature and personal experience that describes the important aspects of system development needed to support high fidelity wraparound and good outcomes for children and families. The presentation will unveil a community assessment tool and process and strategies to address common developmental challenges.

1E.

Pecan & Cedar

**Youth Track.** Youth will have an opportunity to attend a track just for them. Youth are involved in the planning of these activities at this time.

1F.

Magnolia

**Family Track.** Family members will have the opportunity to attend a track tailored just for them. Workshops will include Parent Mentoring/Telling Your Own Story, Youth and Family Communication, and How to Handle a Crisis. Families will also have a hospitality suite available to family members during the conference.

1G.\*

Salon E

**Parent-Child Interaction Therapy: Evidenced-Based Intervention for Young Children with Challenging Behaviors.** *Robin Gurwitch, Ph.D.* Parent-Child Interaction Therapy (PCIT) is an evidenced-based intervention for young children with challenging behaviors. PCIT was one of three intervention protocols identified in the recent *Kauffman Best Practices Project Final Report*. This workshop will provide participants with an overview of PCIT, which is used with children with disruptive behaviors. This workshop will also discuss new applications with at risk children (e.g., children who have been prenatally exposed to alcohol or other drugs, children with a history of physical abuse).

2:30 – 2:45

**Break**

2:45 – 4:15 **Concurrent Workshops. Session 2**

- 2A.\* Sycamore  
**Building a Family-Driven System of Care.** *Jane Adams, Ph.D.*
- 2B.\* Silver Oak A  
**Trauma-focused Cognitive Behavioral Therapy with Children Exposed to Family Violence and Their Nonoffending Caregivers.** *Felicia Neubauer, Ph.D.*
- 2C.\* Birch  
**The S.E.L.F. Model of Trauma Treatment: Creating Sanctuary for Traumatized Children and Adolescents in Residential Treatment.** *Sandra Bloom, M.D.*
- 2D.\* Dogwood  
**Community Development: From Collaboration to Integration.** *Jim Rast, Ph.D. and John VanDenBerg, Ph.D.*
- 2E. Pecan & Cedar  
**Youth Track**
- 2F. Magnolia  
**Family Track**
- 2G.\* Salon E  
**Parent-Child Interaction Therapy: Evidenced-based Intervention for Young Children with Challenging Behaviors. Part. II.** *Robin Gurwitch, Ph.D.*

*Friday, April 29, 2005*

---

- 8:00 – 8:30 **Registration (Please sign in each day.)**  
**Welcome and Introductions.** *Rand Baker*, Deputy Commissioner for Mental Health Services, ODMHSAS.  
Oklahoma Systems of Care Video.
- 8:30 – 9:45\* Sequoia  
**Plenary Session: Brief Strategic Family Therapy in the Treatment of Adolescent Problem Behaviors.** *Jose Szapocznik, Ph.D.* Some adolescents develop multiple problem behaviors such as conflict with parents, school failure, delinquency and drug use. Parents can become the front line of

treatment for these adolescents. Working with the family has proven to be the most effective approach in treating these youth.

9:45 - 10:00 **Break**

10:00 – 11:30 **Concurrent Workshops. Session 3**

3A.\* Redbud  
**Implementing Evidence-Based Practice in Public Sector Service Settings.** *Mark Chaffin, Ph.D.* This 3-hour workshop is intended for policy makers, administrators, clinical supervisors, program directors and others interested in the transportability and implementation of evidence-based treatments and protocols within large public agency service programs. The presentation will review the development and practice culture of evidence-based treatments, then discuss aspects of model implementation including model selection, training and technical assistance, organizational culture and climate factors, individual provider factors, larger service system factors, financial factors and how to promote a change in practice culture from traditional to evidence-based frameworks.

3B. Maple  
**Deafness and the Family: Issues and Applications Relevant to the Impact of Deafness and Hearing Loss on Families in Therapy.** *Patrick Hinson, MS, Ed.S., LMFT.* This presentation will begin by addressing the different aspects of deafness and hearing loss in families. It will address the perceptions of deafness and hearing loss from both sides of the condition and will cover appropriate use of interpreters in family therapy and appropriate techniques for therapists to develop therapeutic alliances with the whole family system. Special emphasis will be placed on the types of disorders often found in families with one or more deaf members who do develop problems relevant for entering therapy, from out-patient family therapy issues to formal psychiatric disorders. We will work to develop a knowledge base for beginning work with families with one or more deaf members entering treatment, whether the deaf family member is the identified patient or a member of the supporting family. Using a Structural Family Therapy framework, the overarching goal will be to facilitate a sense of comfort and competence in the therapeutic role of exploring and addressing the identified problems that such unique families bring to therapy from a strength-based perspective.

3C. (MOVED TO THURSDAY)  
**Parent-Child Interaction Therapy: Evidenced-Based Intervention for Young Children with Challenging Behaviors.** *Robin Gurwitch, Ph.D.*

3D. Dogwood  
**START: An Overview of a Trauma-Informed Curriculum.**  
*Joseph Benamati, MSW*

3E.\*

Silver Oak B

**Parenting is Prevention.** *Karol L. Kumpfer, Ph.D.* This workshop will familiarize participants with the scope of the behavioral health problem in adults and youth, the costs to society, damaging effects, the multiple causes of drug abuse that must be addressed by parenting and family prevention programs, and characteristics of highly vulnerable youth compared to resilient youth. Family prevention programs are designed to reduce risk factors and to increase resistance to behavioral health issues and resilience in general. Family risk and protective factors will be covered as well as the biological and genetic risk factors of children of alcohol and drug abusers.

3F.

Pecan & Cedar

**Youth Track.**

3G.

Magnolia

**Family Track.**

3H.\*

Silver Oak A

**Brief Strategic Family Therapy – How it works.** *Jose Szapocznik, Ph.D.* Videotaped family therapy sessions will be used to illustrate how Brief Strategic Family Therapy works with families of different racial/ethnic backgrounds (Hispanic, African American and Caucasian). Videotapes will be used to illustrate strategies for involving family members, diagnostic approach, and change producing interventions.

3I.\*

Sycamore

**The Human Services Supervisor as an Active Teacher of Staff: Advanced Issues.** *John VanDenBerg, Ph.D.* This institute is for supervisors only. It is advanced, interactive and fast-paced. Supervisors will learn advanced supervisory techniques for promoting a skilled and competent staff. Supervisors will be given hands-on instruction on motivating staff, monitoring staff performance and techniques for increasing skills of staff in a way that builds on their strengths.

11:30 – 1:00

**Lunch (provided for pre-registered participants)**

1:00 – 2:30

**Concurrent Workshops.**

4A.\*

Redbud

**Evidence-Based Practice in Public Sector Service Settings. Part II.**  
*Mark Chaffin, Ph.D.*

4B.

Maple

**Deafness and the Family: Issues and Applications Relevant to the Impact of Deafness and Hearing Loss on Families in Therapy.**  
*Patrick Hinson, MS, Ed.S, LMFT*

4C.\* (MOVED TO THURSDAY) Parent-Child Interaction Therapy: Evidenced-Based Intervention for Young Children with Challenging Behaviors.

*Robin Gurwitch, Ph.D.*

4D. Dogwood  
**START: An Overview of a Trauma-Informed Curriculum.** Part II.

*Joseph Benamati, MSW*

4E.\* Silver Oak B  
**Parenting is Prevention.** *Karol L. Kumpfer, Ph.D.*

4F. Pecan & Cedar  
**Youth Track.**

4G. Magnolia  
**Family Track.**

4H\*. Silver Oak A  
**Brief Strategic Family Therapy – How it works.** Part. II.  
*Jose Szapocznik, Ph.D.*

4.I\* Sycamore  
**The Human Services Supervisor as an Active Teacher of Staff: Advanced Issues.**  
*John VanDenBerg, Ph.D.*

2:30 – 2:45 Break

2:45 – 3:30 Sequoia  
**Plenary Session.** *Joseph Benamati, Ph.D.* In the “Village” of “It Takes a Village to Raise a Child”: Are Parents Seen as Renters or Owners?

**\*Eligible for Continuing Medical Education Credits**

## **FAMILY TRACK SPEAKERS**

### **Susan Boehrer**

Ms. Boehrer is the Executive Director of the Oklahoma Federation of Families for Children's Mental Health, a non-profit organization promoting advocacy, family support, and technical assistance for the Oklahoma Systems of Care Initiative. Ms. Boehrer serves as a State Representative of the Oklahoma Systems of Care as a parent whose child is receiving mental health services. She is a member of the Community Team and Referral Team for Cleveland County's Family Frontier System of Care. Ms. Boehrer serves on the Behavioral Health Development Team for the Partnership for Children's Behavioral Health. She is a state-wide trainer for Oklahoma Systems of Care Initiative and has trained nationally for VROON VANDENBERG, LLP. She represented the state of Oklahoma as Mrs. Oklahoma in 1999 and has spoken at numerous conferences, trainings and panels. Susan and her husband, Terry, are the parents of two adopted children with diagnosed mental illness and behavioral problems.

### **Traci Castles**

Traci is a 1989 graduate of Oklahoma State University with a double major in Marketing and Management. She is a 2002 graduate of Oklahoma's Partners in Policymaking and a 2005 Graduate of Oklahoma's Partners in Education Advocacy class. She is the wife of NEWS 9 meteorologist, Jed Castles, and the mother of three children. All three children have disabilities. Traci is a co-founder of Oklahoma Family network, Oklahoma's statewide parent-to-parent network for parents of children with disabilities. In 2002, Traci received the NAMI Oklahoma Outstanding Professional Organization Award for her work in creating this network. As Family Faculty at the Tolbert Center for Development Disabilities at the OU Health Sciences Center, Mrs. Castles provides a family perspective in coursework for preservice and graduate higher education curriculum participates in development of the STARS program and serves as the parent representative for agency coordination of SoonerStart, Oklahoma's Early Intervention Program. Traci serves as a voice for families on several state committees and councils for disability issues. Since 2001, she has been presenting workshops that reflect her personal experiences as a parent not only in Oklahoma, but also on a national level.

### **Carl Haws**

Carl Haws is the Oklahoma State Trainer for Systems of Care at the Department of Mental Health and Substance Abuse Services. Carl has been working with children with emotional, behavioral and mental disabilities for the last 15 years. He began his career at Shadow Mountain Hospital in Tulsa, Oklahoma as a mental health technician. Within five years, Carl had advanced to the position of supervisor of two adolescent units. Following that position, he accepted a job as a Juvenile Case Manager for Associated Centers for Therapy in Tulsa. Carl also began working as a contractor for the University of Oklahoma training foster parents in behavior crisis management skills. In 2001, Carl accepted the position as Project Director of Tulsa Systems of Care. With his guidance and direction, the pilot project grew from two employees serving ten families to fourteen employees serving one hundred and twenty families. Carl is a part-time consultant for Vroon VanDenBerg, trains nationally on the wraparound practice model, and also provides coaching for wraparound fidelity at Oklahoma's systems of care community sites.

### **Jacquie Pereira**

Jacqueline Pereira is a graduate from the University of Central Oklahoma with a degree in Substance Abuse Counseling. She is a dedicated youth advocate and has worked with youth on various prevention efforts throughout the state addressing issues such as healthy relationships, bullying, substance abuse and suicide prevention. She has also worked on the Oklahoma City Youth Listening Conference. She has worked with Teenline as an AmeriCorp Promise Fellow and now serves as the State Youth Coordinator for the Oklahoma Systems of Care with the Department of Mental Health and Substance Abuse Services. Jacqueline is currently pursuing her Masters in Human Relations from the University of Oklahoma.



# FAMILY TRACK WORKSHOP

*Thursday, April 28, 2005*

---

1:00-2:30 **Parent and Youth Communication.** This workshop, lead by Jacquie Pereira, Youth Coordinator and Susan Boehrer, Oklahoma Federation of Families, will be hands on communication activities for parents and youth. We will hear from a panel of youth and their parents on real life communication problems and solutions. We will have fun finding out what we have in common and learning to respect how we are different. You will leave this workshop with a better understanding of how to bridge the communication gap between youth and parents.

2:45-4:45 **Crisis Management at Home.** Carl Haws, SOC Trainer and Susan Boehrer, Oklahoma Federation of Families, will teach families how to manage crisis within the home. Learn how to make and follow a crisis plan. Understand how to prevent crisis if possible, manage crisis if necessary, and how to let good crisis management make your family stronger and more durable. You will leave this workshop with knowledge that will help your family manage the bumps that youth and families experience with planning and control.

*Friday, April 29, 2005*

10:00-11:30 **Telling Your Story.** Traci Castles, Oklahoma Family Network, will train families to tell their story in a meaningful and organized manner that promotes awareness and sensitivity. This curriculum adapted from “Telling Your Story” by Jan Moss, will help families develop their personal experience story in a way that reveals important issues and promotes feedback and support from their audience. This two-part workshop will promote healing and help families move forward as they learn how to network among themselves, support each other, and see the value of their own personal stories.

1:00– 2:30 **Telling Your Story.** Continued

## **CONFERENCE EXHIBITORS**

**Crewson Youth Center**

**Dayspring Behavioral Health Services**

**Five Oaks Achievement Center**

**Heartspring School**

**IPS**

**Keystone Education and Youth**

**National Alliance for the Mentally Ill**

**NRCYS**

**OASIS Information and Referral**

**Oklahoma Department of Mental Health and Substance Abuse Services**

**OK Child Traumatic Stress TX**

**Oklahoma Youth Center**

**OSU – American Indian into Psych**

**Mental Health and Substance Abuse Services Administration**

**Sunbeam Family Services**

**Thunderbird Youth Academy**

**Timber Ridge Ranch**

**Verna's Jewelry**

**TK Wolf**

**Wraparound Tulsa (ACT)**

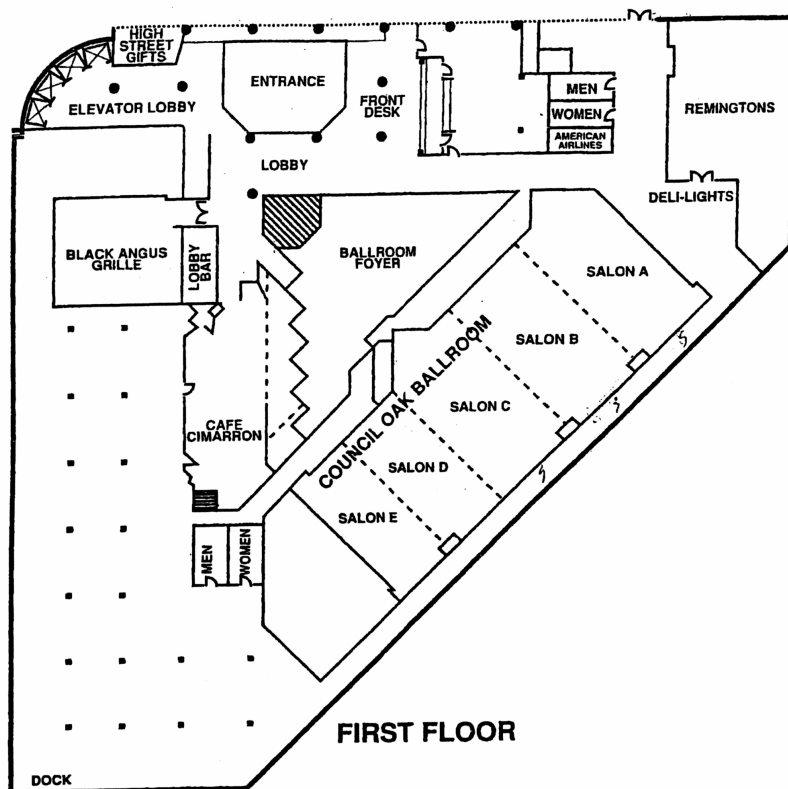

TULSA  
**Marriott.**  
 SOUTHERN HILLS

1902 East 71st Street, Tulsa, Oklahoma 74136 (918) 493-70

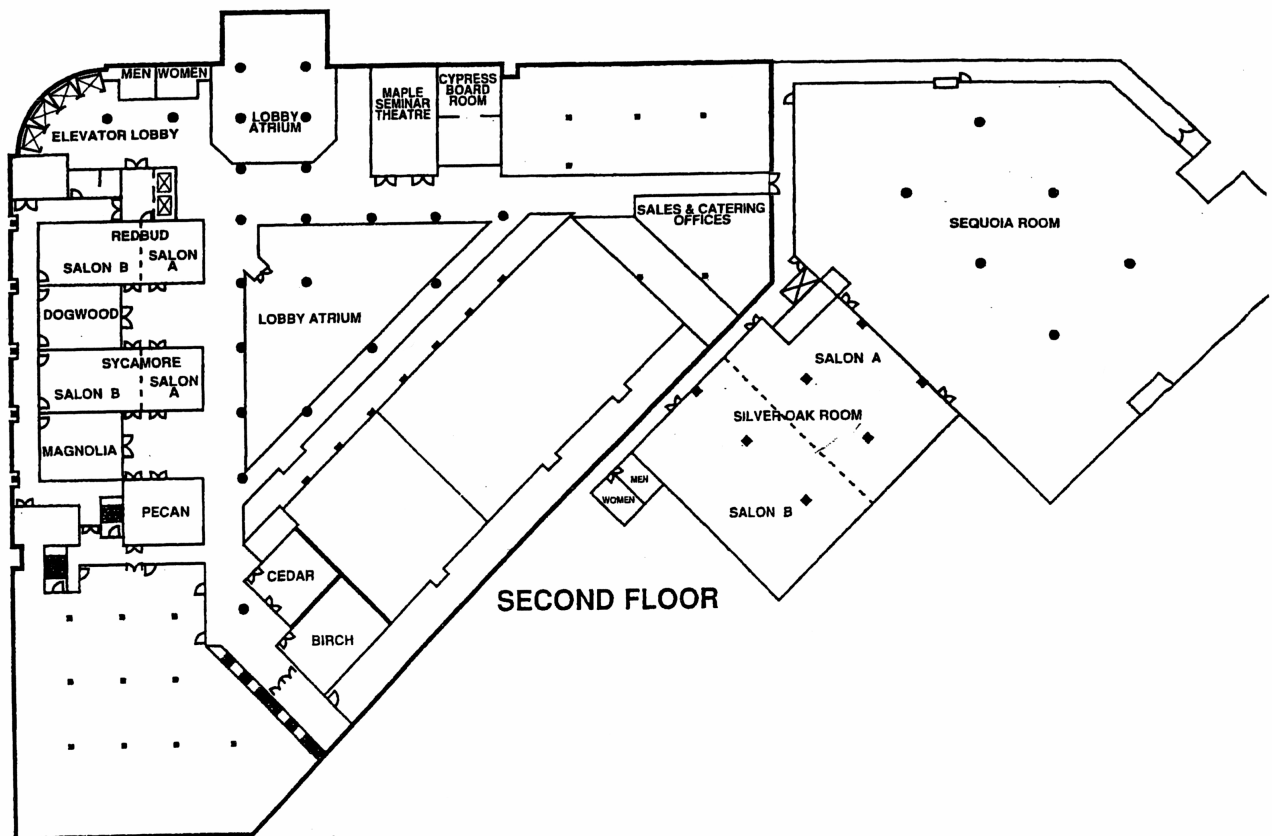





**Child Centered**  

---

**Community Based**  

---

**Culturally Competent**